

BURNBANKS

MODEL SETTLEMENT

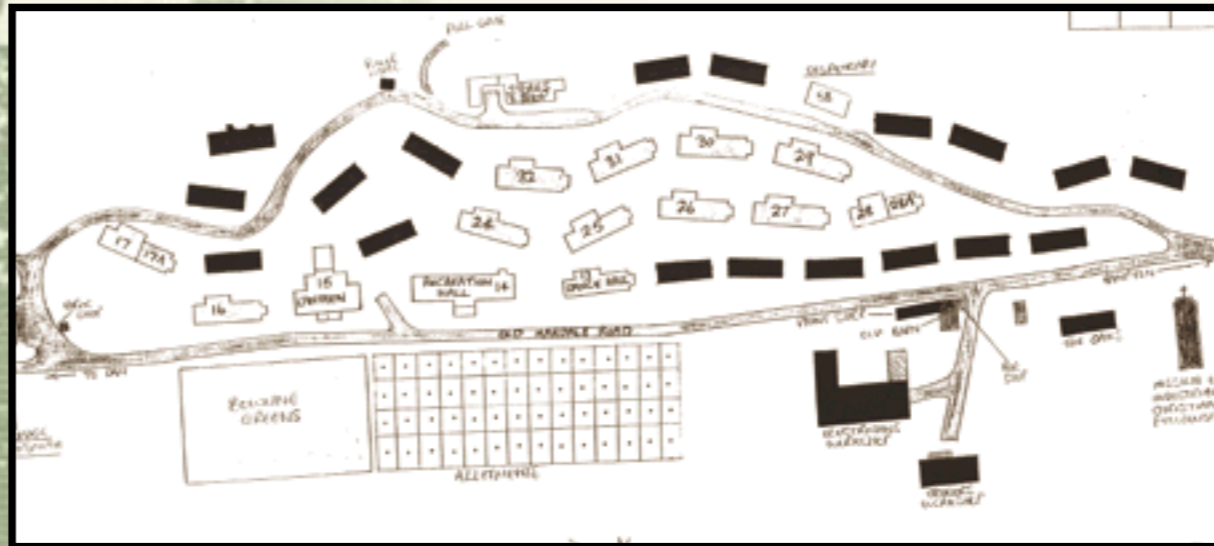

Burnbanks 1935



Burnbanks 2005

Research by Bampton and District Local History Society
supported by Local Heritage Initiative funding.

BURNBANKS

MODEL SETTLEMENT

THE HAWESWATER SCHEME

Lake District water is a precious commodity - it moulds the local landscape, supports agriculture, and encourages sport and tourism. From the mid-nineteenth century, Lancashire's growing industrial towns saw water as essential for their well-being. Manchester, the strongest and most enterprising of local authorities, looked first to Thirlmere and then to Haweswater to provide for its own needs: it also planned to sell water to rural and urban areas across north-west England, including Liverpool.

